

# Manual Wood Concrete Fence.

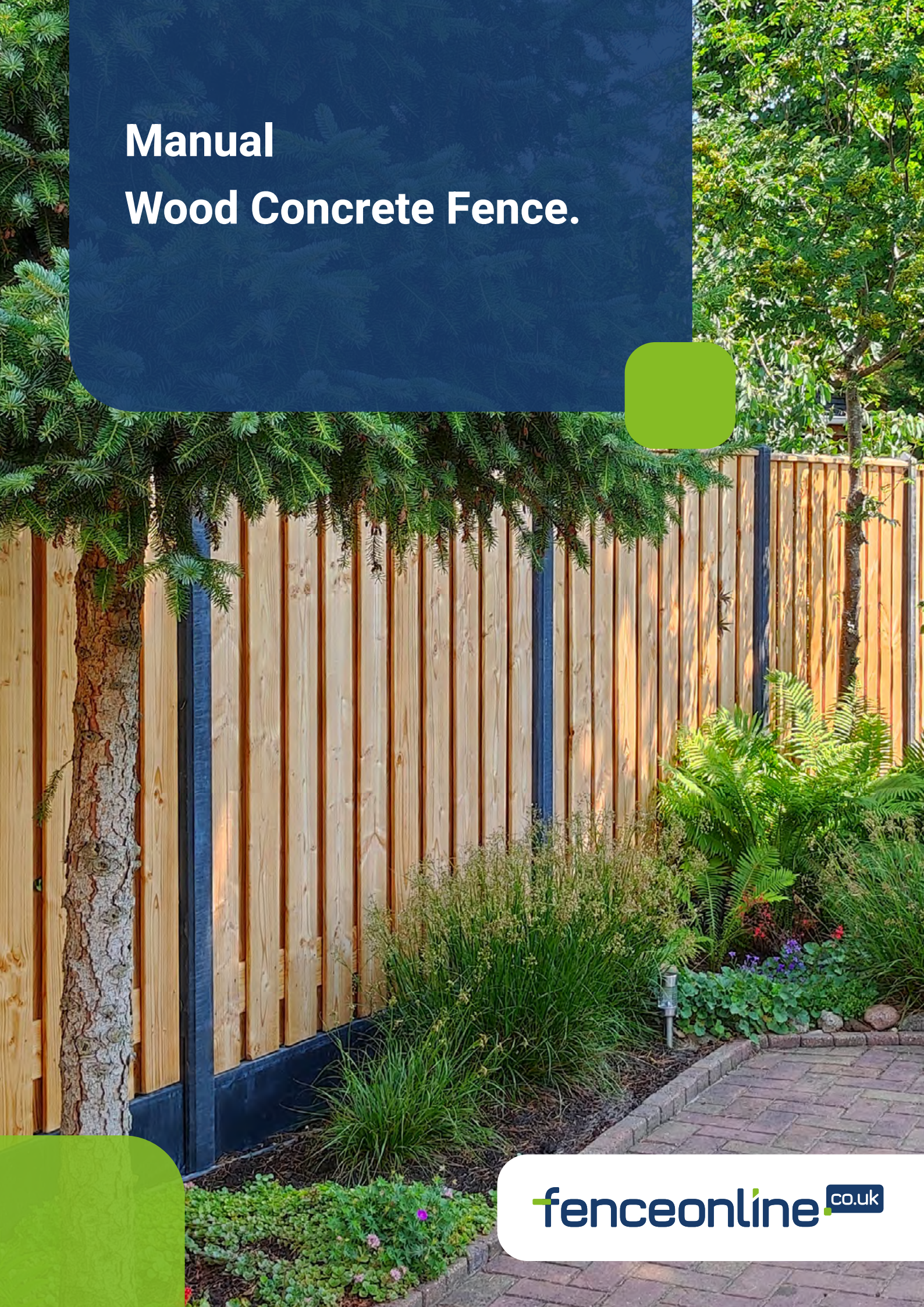



# Personal protective equipment.

Wood concrete fence



# What is needed to install the fence?

Wood concrete fence

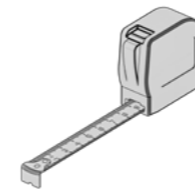

Tape measure



Rope / wire



Spade /  
Soil auger



Electric  
screwdriver

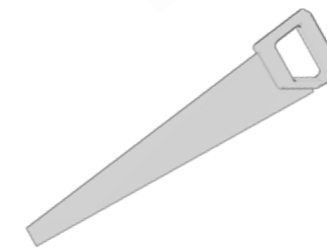

Reciprocating  
saw or handsaw.

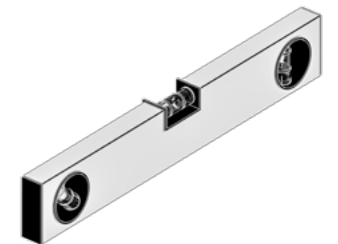

Level

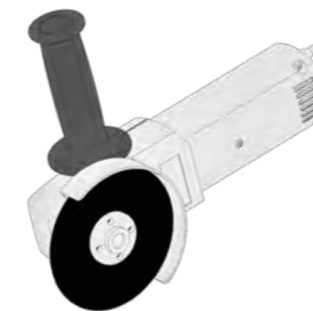

Angle grinder  
with diamond disc

**Maak het jezelf nog makkelijker!  
Het volgende gereedschap zorgt  
voor nog meer montage gemak.**

- Blanket, for a soft surface.
- Boxcutter



## Check your order

Wood concrete fence

The fence panels, the concrete posts and concrete slabs, any gate and (quick)-concrete mortar are delivered on a pallet and are strapped. Depending on the size of the order, the posts and plates are delivered on a second pallet. For small orders, the panels are placed upright on the concrete piles and then bonded and sealed.

Keep the order in a safe and covered place until assembly to keep it in optimal condition.

Carefully cut the green band with which the products are tied.



## Haal de producten voorzichtig van de pallet af.

Wood concrete fence



Check the goods upon delivery and note any damage on the consignment note before signing. **(after signing the right of complaint expires).**





# Overview and dimensions wood concrete fence.

Wood concrete fence

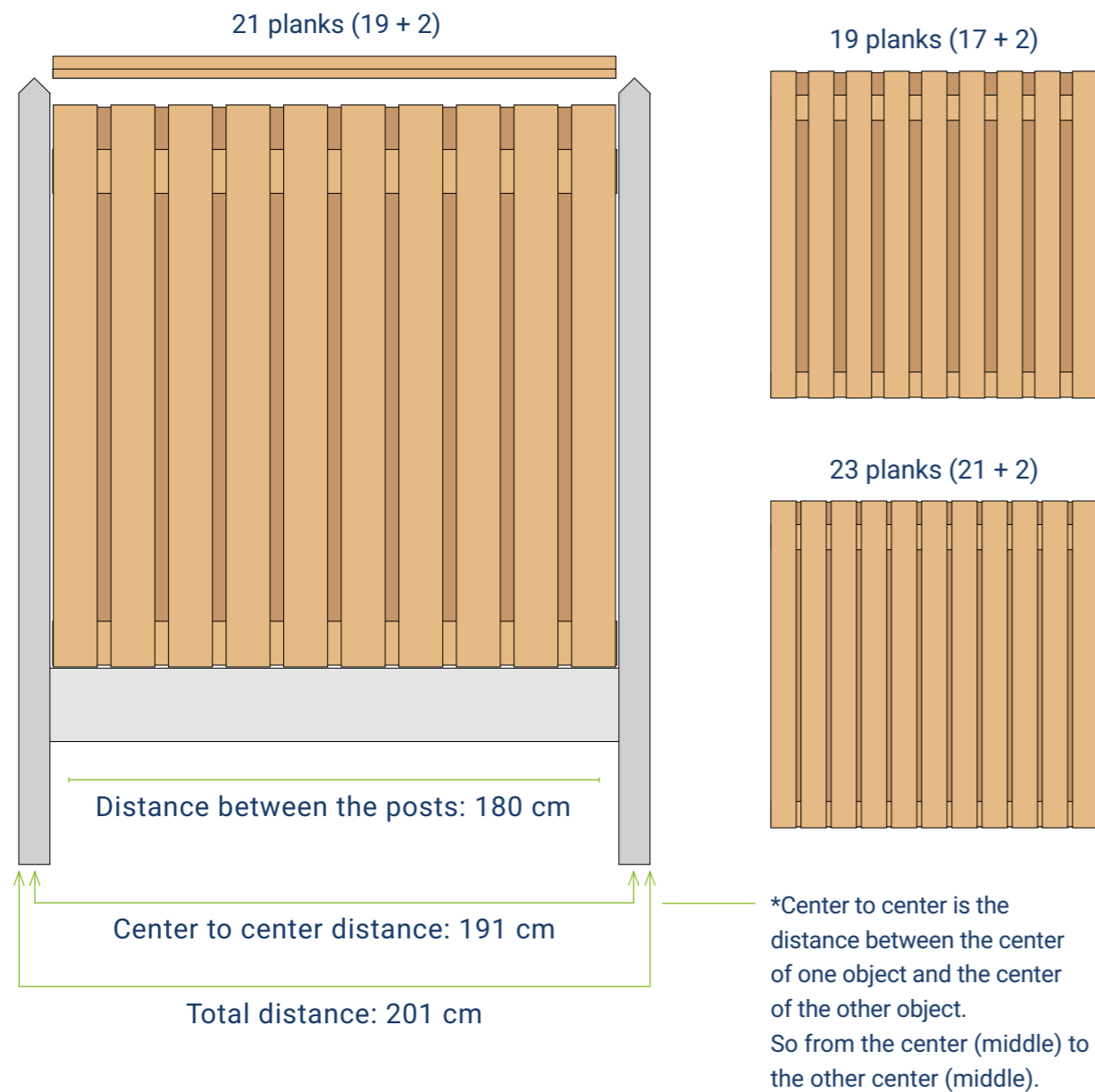

# Preparation: Measuring is knowing.

Wood concrete fence

- 1 Level the ground at the location where the fence will be placed. Free up enough space to work properly.
- 2 Determine the starting point of your fence. If you have a corner in your fence, you can start at the corner post.
- 3 Measure where the concrete posts are to be placed. For correct positioning of the posts, measure from the center of the posts. (The center to center\*) You measure from the center of the first post 191 cm to the center of the second post. The measurement is mainly to see if you encounter any obstacles when placing the posts. You place a post each time and against it the concrete slab, then you dig the second hole and place the second post, then the second concrete slab, the third post, etc. This way you always have the posts positioned correctly.
- 4 Drill or dig a hole of approx 70 cm deep at the place where the first pile is to be placed. Remove any stones, roots or other material from the ground where the posts will be placed.





## Assembly: Holes in the ground.

Wood concrete fence

It is wise to carry out the assembly of the fence with two or more people.

Do you put the first post against a wall? In that case, before fixing the first pile in the concrete, the universal fitting must be fixed. (See page "Attaching Uni fittings")  
When fixing the uni fittings you must be able to reach both sides of the posts.  
The same goes for the last post.

**Poles once set in concrete are not easy to move.**

- 5 Place the first post in the hole.  
Check that it is at the correct height and tight against the tensioned wire.  
Correct the height if necessary.

Then add (rapid) concrete in the hole and add some water. If the soil is moist, little water is needed.

Check that the post is level and make sure the post does not move until the concrete has set.

For correct use of the (quickdrying) concrete mortar, see the instructions for use on the packaging.



## Assembly: Measuring is knowing.

Wood concrete fence





## Assembly: Uni fittings on the first post.

Wood concrete fence

- 6 Stretch a wire from the first post to the location of the last post, along which your fence must be placed. Use if necessary. stakes at the end of the wire. Stretch the wire 5 cm to the left or right of the center of the fence.



## Assembly: Digging a trench for the first concrete slab.

Wood concrete fence

- 7 Dig next to the hole for the post a 180 cm trench into which the concrete slab will be placed. You can choose how far you let the concrete slab disappear into the ground and therefore how deep the trench should be, this also has an effect on the height of the fence. We recommend that the concrete slab disappear into the ground at least 5 cm. You can choose to place two slabs on top of each other for a higher fence. Special posts are needed for this fence.

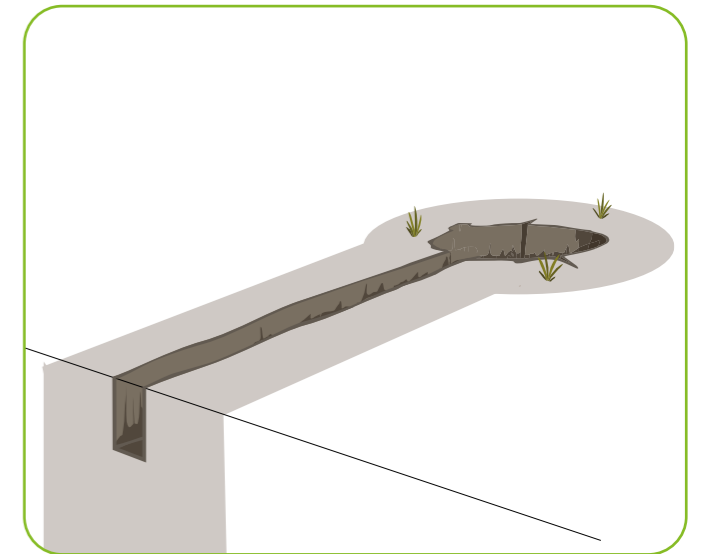



## Assembly: The first concrete slab.

Wood concrete fence

- 8 Place the concrete slab in the trench. Make sure the plate falls into the slot of the post. The plate must always rest on the ground and not just on the slot of the posts.



## Assembly: The second post in the ground.

Wood concrete fence

- 9 Then dig a new hole for the next post and place the post against the concrete slab. Make sure the post is placed against the wire. Then tamp the concrete slab and check whether it is level. Then fix the post with concrete again and check whether the post is also level. Repeat this for all posts and slabs.





## Assembly: Shortening of fence and concrete slab.

Wood concrete fence

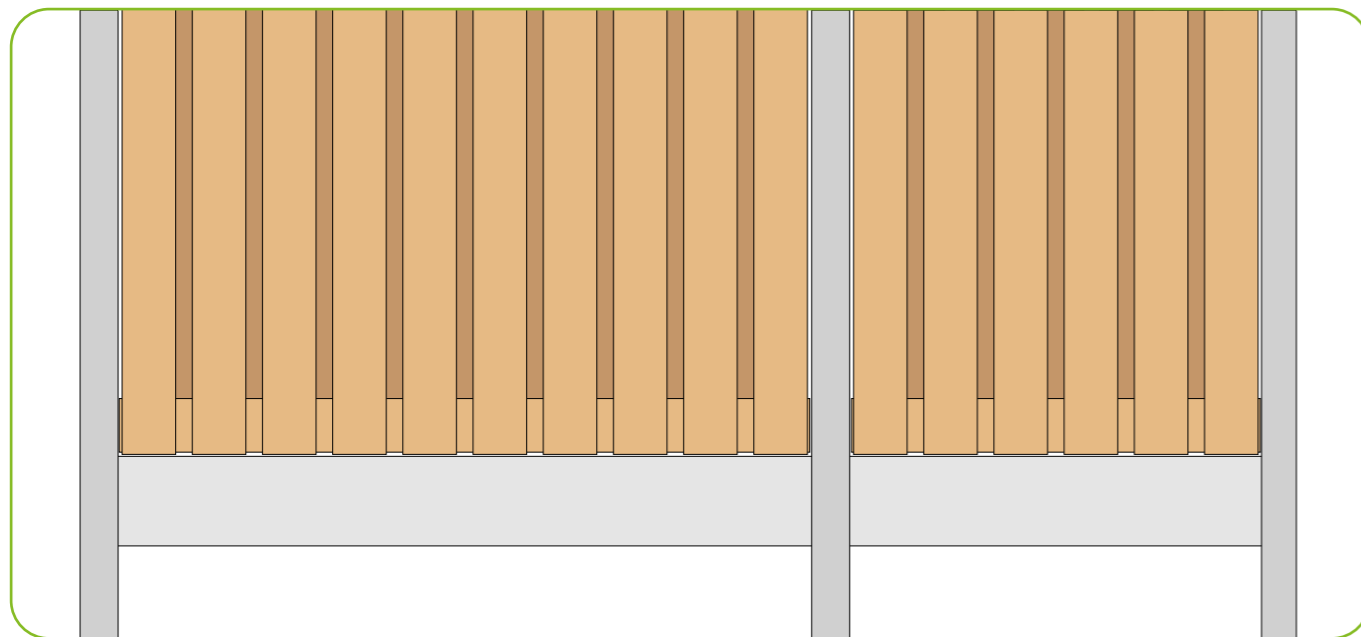

Does the length of the last concrete slab not quite meet the last part of the fence? Then you will have to shorten the plates and the fence.

Please note, our concrete products are all reinforced with steel and will have to be cut with an angle grinder with a diamond cutting disc.



## Assembly: Fix all Uni fittings.

Wood concrete fence

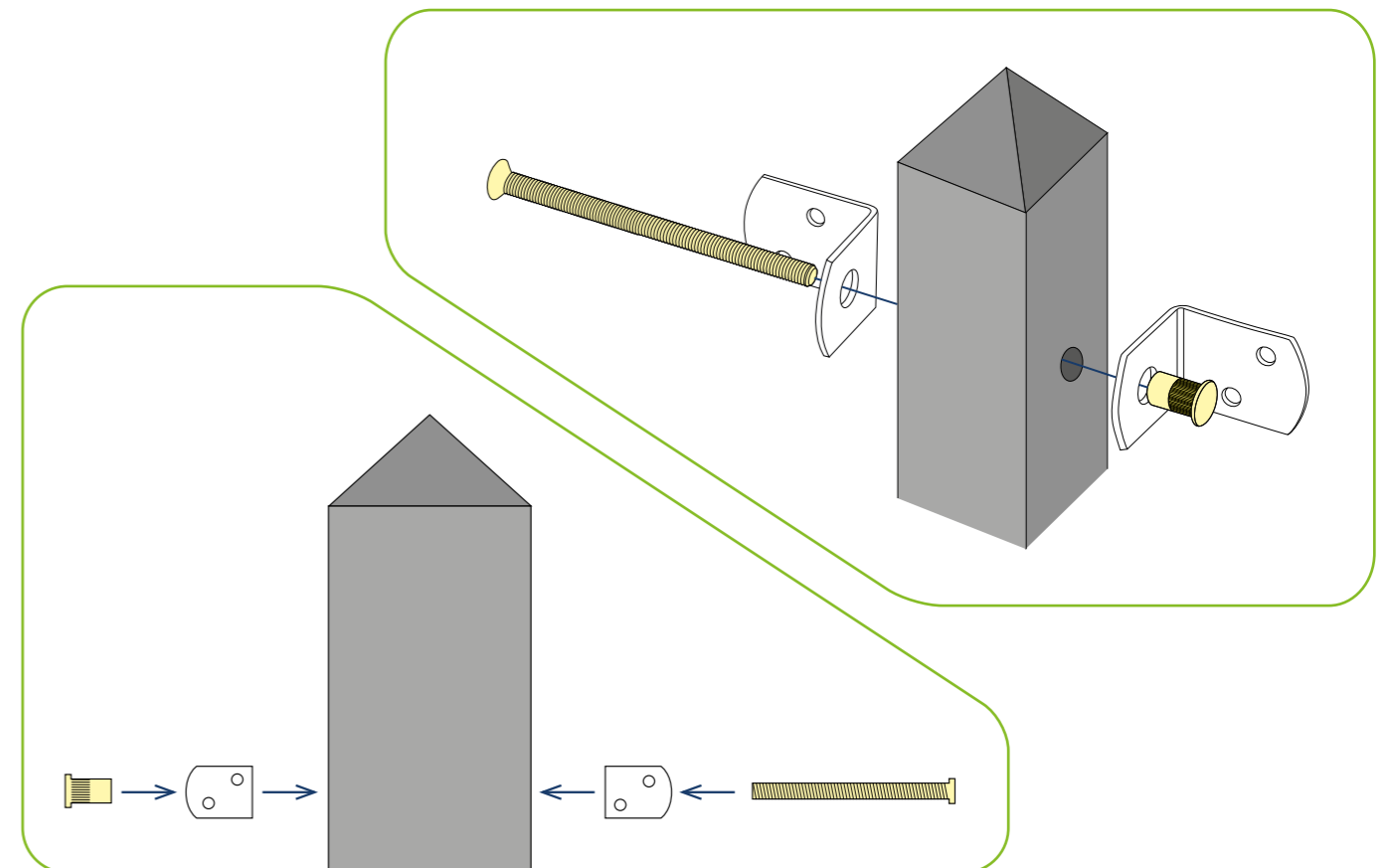

- 10 When all concrete has hardened, you can attach the uni fittings to all posts. Hold the plates over the pre-drilled holes in the post and insert the bolt into the hole. Screw the screw cap onto the bolt and tighten it securely.



## Assembly: Assembling the wooden fence panels.

Wood concrete fence

- 11** Place the first fence panel on the concrete slab and place it against the connecting corners of the universal fitting. Check with the spirit level whether the panel is straight.



- 12** Screw the fence panels to all four connecting corners. Repeat for all panels.



**Tip:** You may drop a screw during assembly. To prevent you from losing it, you can place a blanket or plastic bag at the bottom of the pole that will catch it.

## Assembly: Adjust the width of the fence panels

Wood concrete fence

- 13** When the posts are mounted correctly, level and set firmly in concrete, the fence panels fit exactly between the posts. If it turns out that you have a little too much or too little space between the posts, you can unscrew one or both outer planks and extend them a little more. This makes the fence panel slightly wider or narrower.

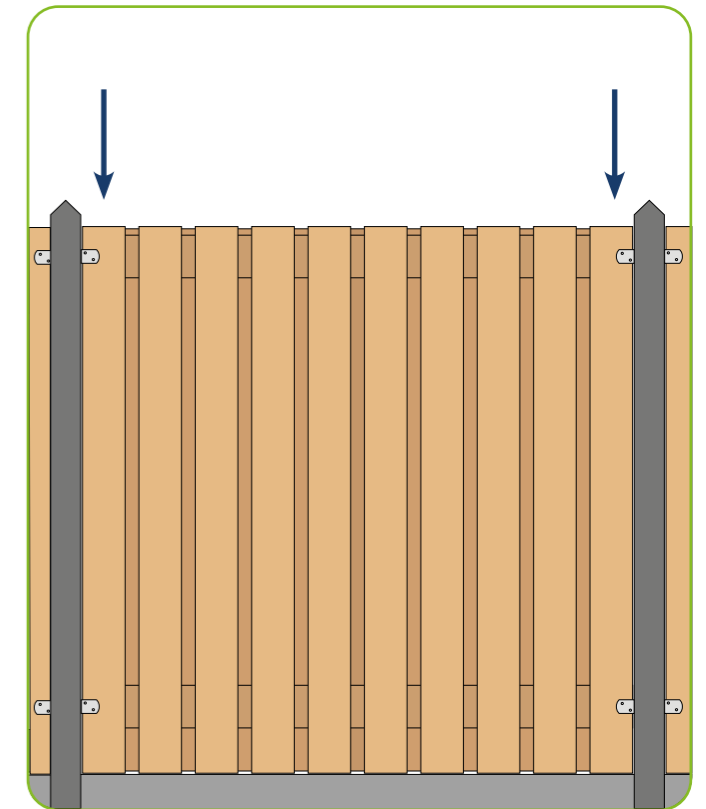



## Assembly: Place cover caps.

Wood concrete fence

- 14 Place a cover cap on top of the first fence panel and push it tightly against the fence and push all cover caps against the same side of the fence. This way you keep a straight line at the top of the fence. Try to save some space both sides between the cover cap and the concrete post, so the wood can work.



## Congratulations! Your fence is installed!

Wood concrete fence

Level the sand and check whether the concrete slabs are sufficiently in the ground. Add sand if necessary to ensure that the concrete slabs are firmly in the ground. Your fence is now complete! Enjoy it!



- 17 Do not forget to take pictures of your fence and send them to: [customerservice@fenceonline.co.uk](mailto:customerservice@fenceonline.co.uk) Or post them with #fenceonline!



**You made a good choice,  
these people also bought  
this fence!**

Wood concrete fence



Did you find this manual useful?  
We would love to hear your feedback!



Send your reactions to:  
[customerservice@fenceonline.co.uk](mailto:customerservice@fenceonline.co.uk)